

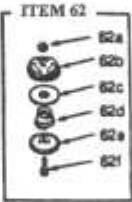

ICM-10C

G.D.B. INC.

1291, route 235, Bedford, (Québec) J0J 1A0
 Tél. : (450) 248-3135 Fax : (450) 248-4740

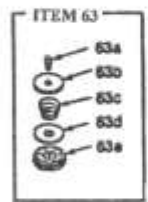
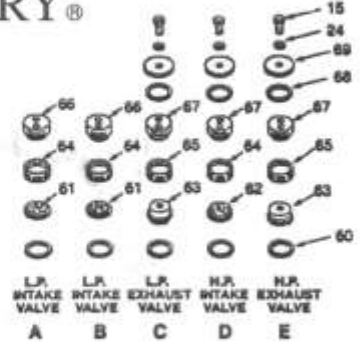
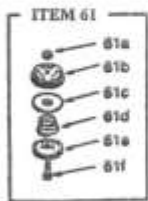
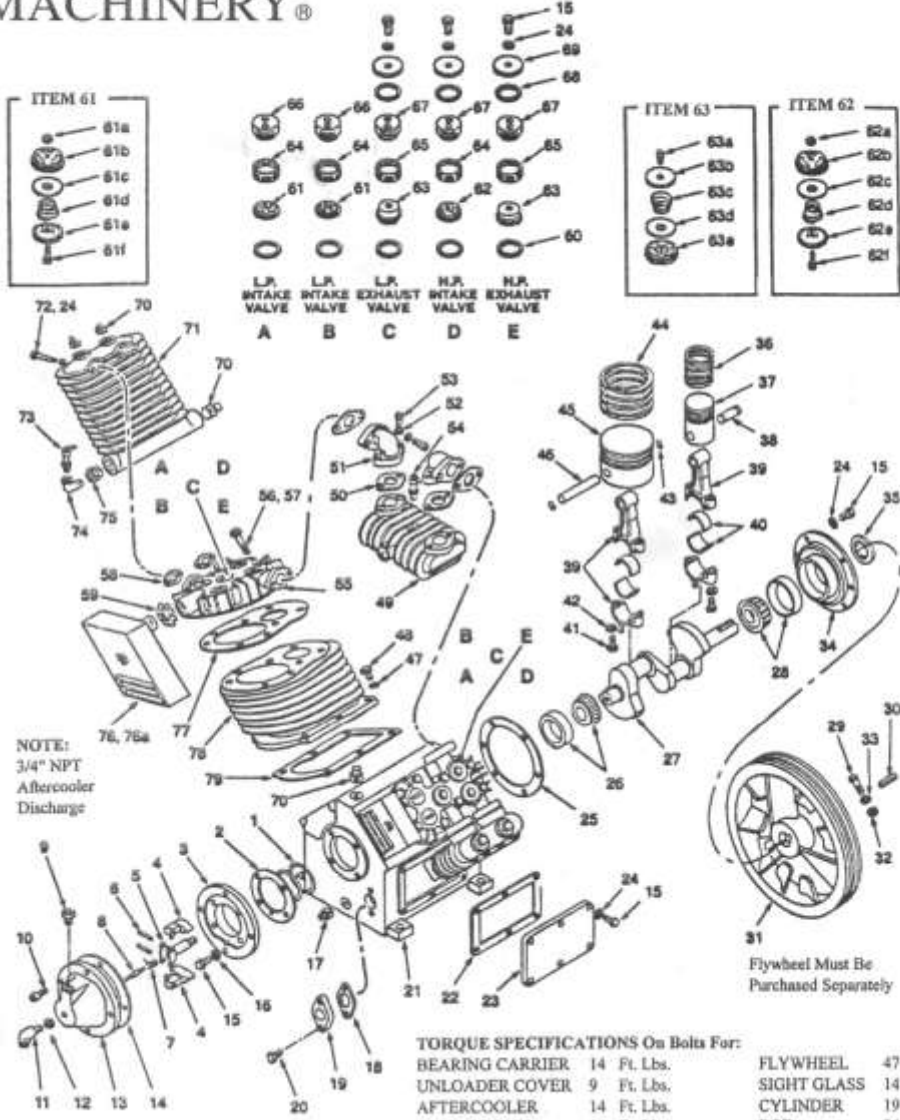

NOTE:
 3/4" NPT
 Aftercooler
 Discharge

TORQUE SPECIFICATIONS On Bolts For:

BEARING CARRIER	14 Ft. Lbs.	FLYWHEEL	47 Ft. Lbs.
UNLOADER COVER	9 Ft. Lbs.	SIGHT GLASS	14 Ft. Lbs.
AFTERCOOLER	14 Ft. Lbs.	CYLINDER	19 Ft. Lbs.
INTERCOOLER	14 Ft. Lbs.	ROD	34 Ft. Lbs.
VALVE RETAINERS	51 Ft. Lbs.	HEAD	32 Ft. Lbs.
VALVE COVER	14 Ft. Lbs.	VALVE	9 Ft. Lbs.
SIDE COVER	14 Ft. Lbs.		

G.D.B. INC. 1291, route 235, Bedford, (Québec) J0J 1A0
 Tél. : (450) 248-3135 Fax : (450) 248-4740

ICM-10C

ITEM	PART NO.	DESCRIPTION	QTY.
1	ACP046-0175	SHIM - Bearing Adj., .005 Thick	And / Or
	ACP046-0176	SHIM - Bearing Adj., .010 Thick	And / Or
	ACP046-0177	SHIM - Bearing Adj., .020 Thick	A/R
2	ACP046-0227	GASKET - Adapter Plate	1
3	ACP077-0070	PLATE - Adapter, Centrifugal Unloader	1
4	ACP096-0009	WEIGHT	2
5	ACP114-0112	HOLDER - Weight	1
6	ACP107-0015	PIN	2
7	ACP055-0051	SPRING	1
8	ACP078-0011	PLUNGER	1
9	ACP056-0018	BREATHER - Crankcase	1
10	ACP059-0156	BOLT - M6 x 20mm Lg.	4
11	ACP031-0034	VALVE - Air, w/ Valve Core	1
12	ACP058-0084	NUT - Brass, M10	1
13	ACP077-0071	HOUSING - Centrifugal Unloader	1
14	ACP046-0171	GASKET	1
15	ACP059-0166	BOLT - M8 x 20mm Lg.	23
16	ACP060-0070	WASHER - Lock, 8mm	4
17	ACP062-0004	PLUG - Oil Drain	1
18	ACP046-0178	GASKET - Sight Glass Flange	1
19	ACP032-0031	FLANGE - w/ Sight Glass	1
20	ACP059-0153	BOLT - M8 x 30mm Lg.	2
21	ACP049-0028	CRANKCASE	1
22	ACP046-0170	GASKET - Side Cover	1
23	ACP077-0072	COVER - Side	1
24	ACP060-0061	WASHER - Copper .52" O.D. x .32" I.D.	26
25	ACP046-0168	GASKET - Front Cover	1
26	ACP051-0054	BEARING SET - Rear	1
27	ACP053-0052	CRANKSHAFT	1
28	ACP051-0053	BEARING SET - Front	1
29	ACP059-0163	BOLT - M16 x 80mm Lg.	1
30	ACP146-0015	KEY - Flywheel	1
31	ACP044-0051	FLYWHEEL - 19" O.D. Must Be Purchased Separately	1
32	ACP058-0086	NUT - M16	1
33	ACP060-0069	WASHER - Lock, 16mm	1
34	ACP045-0044	BEARING CARRIER - Front	1
35	ACP046-0179	SEAL - Shaft	1
36	ACP054-0127	RING SET - High Pressure	2
37	ACP048-0055	PISTON - High Pressure	2
38	ACP052-0028	PIN - Wrist, High Pressure	2
39	ACP047-0054	ROD - Connecting	4
40	ACP051-0055	INSERT - Bearing	4 Pair
41	ACP059-0154	BOLT - Rod, M10 x 45mm Lg.	8
42	ACP060-0072	WASHER - Lock, 10mm	8
43	ACP054-0119	RING - Retaining	4
44	ACP054-0126	RING SET - Low Pressure	2
45	ACP048-0054	PISTON - Low Pressure	2
46	ACP052-0027	PIN - Wrist, Low Pressure	2
47	ACP060-0063	WASHER - Copper, .66 O.D. x .41 I.D.	12
48	ACP059-0159	BOLT - Cylinder, M10 x 30mm Lg.	12
49	ACP082-0013	AFTERCOOLER	1
50	ACP046-0172	GASKET - Manifold, Aftercooler	4
51	ACP083-0008	ELBOW - Manifold, Aftercooler	2
52	ACP060-0070	WASHER - Lock, 8mm	8
53	ACP059-0158	BOLT - Manifold, M8 x 25mm Lg.	8
54	ACP136-0047	VALVE - Pressure Relief, 225 PSI	1
55	ACP043-0055	HEAD - Cylinder	1
56	ACP059-0167	BOLT - Head, M12 x 70mm Lg.	16
57	ACP060-0105	WASHER - M12	16
58	ACP046-0173	GASKET - Intercooler	4
59	ACP058-0087	NUT - Conduit, 1"	2

ICM-10C

ITEM	PART NO.	DESCRIPTION	QTY.
60	ACP060-0062	WASHER - Copper 1.62" O.D. x 1.368" I.D.	10
61	ACP043-0098	INTAKE VALVE ASSY - Low Pressure	4
62	ACP043-0099	INTAKE VALVE ASSY - High Pressure	2
63	ACP043-0100	EXHAUST VALVE ASSY - High & Low	4
64	ACP043-0094	SPACER - Intake Valve	6
65	ACP043-0095	SPACER - Exhaust Valve	4
66	ACP058-0082	RETAINER - Valve, Low Pressure	4
67	ACP058-0083	RETAINER - Valve Low Pressure Exhaust Or High Pressure Intake and Exhaust	6
68	ACP046-0174	GASKET - Valve Cover	6
69	ACP077-0073	COVER - Valve	6
70	ACP062-0006	PLUG - Pipe, 3/4" NPT	7
71	ACP082-0012	INTERCOOLER	2
72	ACP059-0157	BOLT - M8 x 90mm Lg.	8
73	ACP136-0039	VALVE - Pressure Relief, 75 PSI	2
74	ACP064-0022	ELBOW - 90° Street, 1/4"	2
75	ACP063-0006	FLUSHING - Reducer	2
76	ACP019-0097	FILTER CANISTER ASSY Includes Item 76a	2
76a	ACP019-0023	ELEMENT - Filter Replacement	2
77	ACP046-0166	GASKET - Cylinder Head	2
78	ACP050-0030	CYLINDER	2
79	ACP046-0167	GASKET - Cylinder / Crankcase	2
SERVICE PARTS KITS			
	ACP046-0185	Complete Gasket Kit For 10 HP Includes:	
	ACP046-0167	GASKET - Cylinder / Crankcase	2
	ACP046-0168	GASKET - Front Cover	1
	ACP046-0170	GASKET - Side Cover	1
	ACP046-0171	GASKET	1
	ACP046-0172	GASKET - Manifold, Aftercooler	4
	ACP046-0173	GASKET - Intercooler	4
	ACP046-0174	GASKET - Valve Cover	6
	ACP046-0178	GASKET - Sight Glass Flange	1
	ACP046-0227	GASKET - Adapter Plate	1
	ACP060-0061	WASHER - Copper .52" O.D. x .32" I.D.	26
	ACP060-0062	WASHER - Copper 1.62" O.D. x 1.368" I.D.	10
	ACP060-0063	WASHER - Copper, .66 O.D. x .41 I.D.	12
	ACP046-0186	Valve Gasket Kit For 10 HP Includes:	
	ACP046-0174	GASKET - Valve Cover	6
	ACP060-0061	WASHER - Copper .52" O.D. x .32" I.D.	6
	ACP060-0062	WASHER - Copper 1.62" O.D. x 1.368" I.D.	10
	ACP078-0020	Centrifugal Unloader Assembly Kit Includes:	
	ACP055-0051	SPRING	1
	ACP078-0011	PLUNGER	1
	ACP096-0009	WEIGHT	2
	ACP107-0015	PIN	1
	ACP114-0112	HOLDER - Weight	1
	ACP165-0065	Overhaul Kit For 10 HP Includes:	
	ACP019-0023	ELEMENT - Filter Replacement	2
	ACP046-0179	SEAL - Shaft	1
	ACP046-0185	Complete Gasket Kit	1
	ACP051-0055	INSERT - Bearing	4 Pair
	ACP054-0126	RING SET - Low Pressure	2
	ACP054-0127	RING SET - High Pressure	2